

SERVICE BULLETIN

SB No.

120

Issue No.

3

TITLE
INSPECTION OF RUDDER BAR SUPPORT BRACKETS
CLASSIFICATION

This Service Bulletin has been classified by the CAA as Mandatory

COMPLIANCE a) Inspection within 7 days of receipt unless previously inspected by Issue 2
 b) Rectification, if required, within 150 hrs

This Issue 3 supersedes Issue 2

APPLICABILITY:

T67B, T67C Series, T67M (Works No.1999 Not applicable), T67M-MkII, T67M200, T67M260 and T67M260-T3A.

INTRODUCTION:

Cases have been reported of cracking in the following brazed joints on the rudder pedal bar support bracket T67M-45-245: inboard pin joint and web to pin joint.

This S.B. requires the inspection to be carried out on all four rudder bar support brackets.

ACTION:

1. Gain access to rudder bar support brackets, ref. Fig. 1.
 - 1.1 Establish whether the brackets are brazed or welded. Welded items should have prominent fillets. If in doubt remove paint from joint. Welded joint will have natural metal colour. Restore finish.

Note: Epoxy paint used on aircraft Works No. 2109 and subsequent, Cellulose Pre Works No. 2109.

- 1.2 If brazed joint identified continue as below.

ISSUED BY:

 for and on behalf of **SLINGSBY AVIATION LIMITED**
 Kirkbymoorside, York YO6 6EZ, England

 Tel. 01751 432474
 Fax 01751 431173

Date 12.5.97

Page 1 of 3

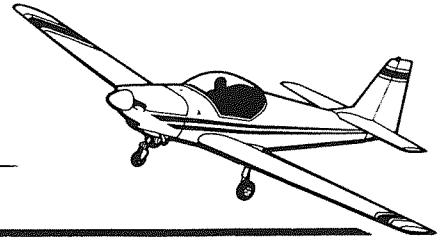
**SERVICE BULLETIN**

SB No.

120

Issue No.

3

TITLE

INSPECTION OF RUDDER BAR SUPPORT BRACKETS

CONTINUED

2. Check brazed joints for cracking Ref Fig. 1 View on Arrow A.
 - 2.1 If no cracks are found, annotate logbook SB120 Iss 3 satisfied. Repeat inspection at 150 hour intervals.
 - 2.2 If cracking is found.
 - 2.2.1 Provided web crack is no more than 50% of the joint length, and the outboard joint to the pin is intact, flying is permitted, but bracket is to be replaced within 150 hours.

It is acceptable to have pin inboard joint with a 100% failure and still fly for up to 150 hours.
 - 2.2.2 Should web crack exceed 50% of its joint length and 100% of pin inbd joint cracked, then no further flight is permitted until bracket is repaired or new item fitted.
3. Following inspection rectification 150 hr inspection still to apply.

For replacement brackets or repair information, contact SAL Product Support Department.

Approved:

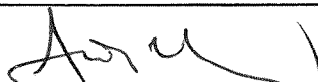

Date:

12.5.97

Page

2

of

3

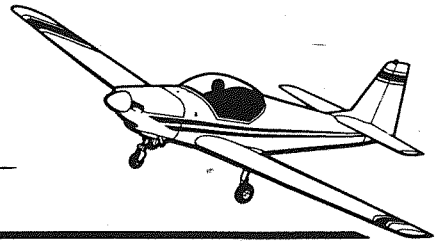

SERVICE BULLETIN

SB No. 120

120

Issue No. 3

3

TITLE

INSPECTION OF RUDDER BAR SUPPORT BRACKETS

CONTINUED

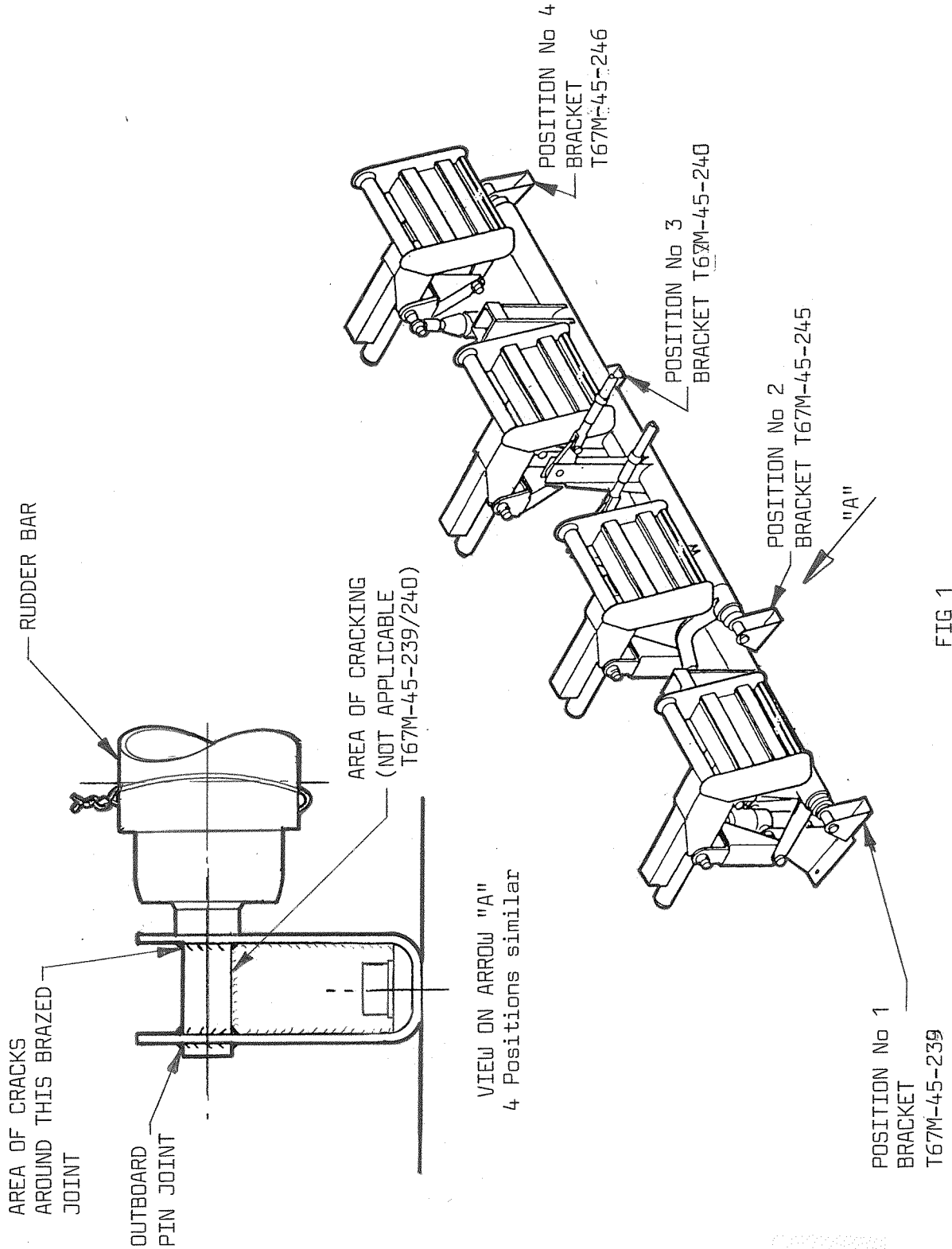

FIG 1
RUDDER PEDAL MECHANISM

Approved:

Date: 12.5.97

Page 3 of 3